

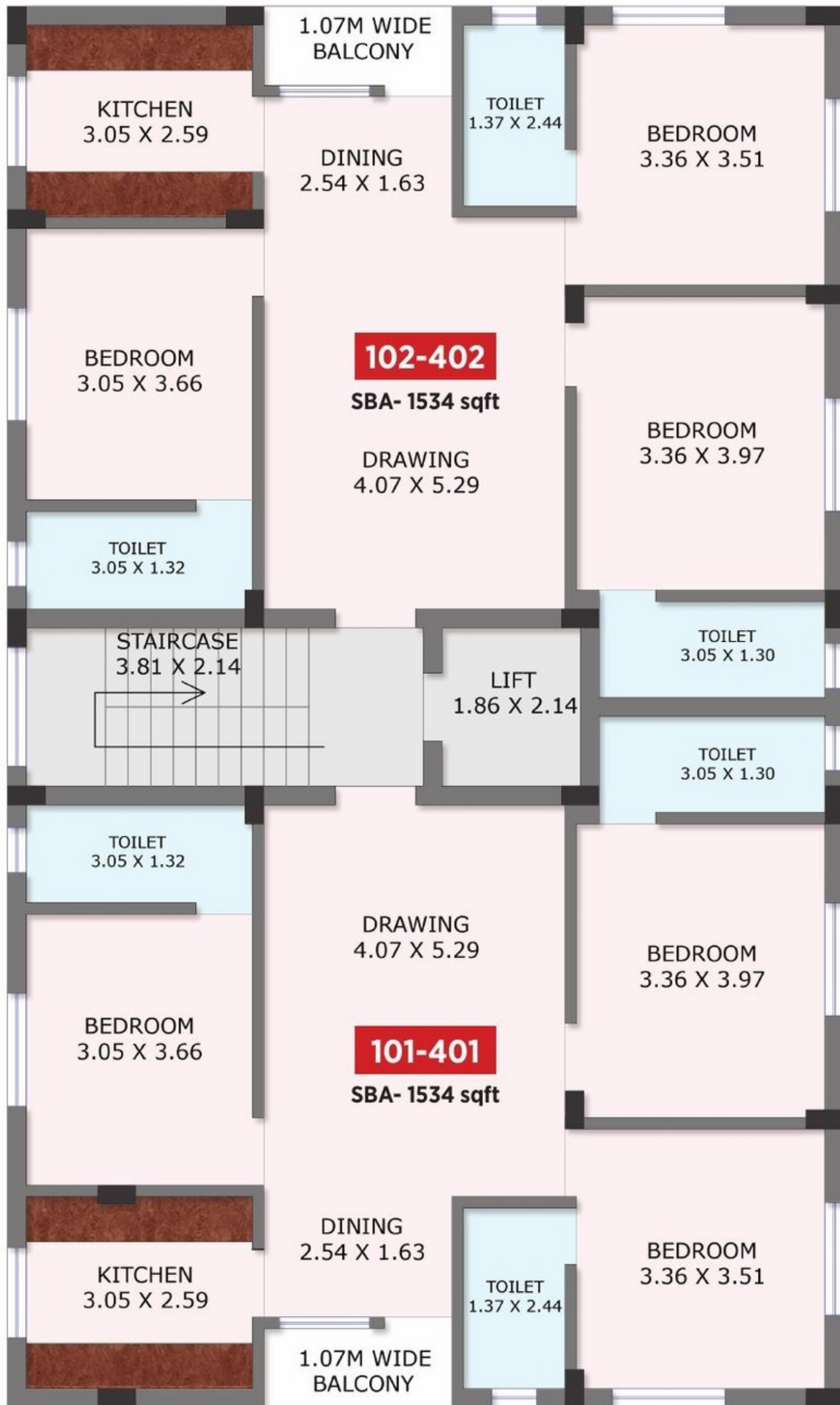

BHPL ARYA

Near SUM Ultimate Medicare, Ghatikia, Bhubaneswar



FACILITIES

Excellent location.

Car parking facilities.

Power backup generator facilities.
(200 Watts for each flat and common areas)

Intercom facilities.

Round the clock security & Water Supply.



SPECIFICATION:

STRUCTURE:

R.C.C. Framed Structure with Column & Beams

FLOORING:

Vitrified Flooring with 4" Skirting

KITCHEN:

Granite Platforms Stainless Steel Sinks
Tiles up to 2'0" heights over Platform.

DOORS:

Main Door Teak Wood
All inside Doors Flush Doors.

WINDOWS:

Powder Coated Aluminum sliding Windows with Safety MS Grill.

BATH ROOMS:

C.P. Fittings of Parryware, Jaguar Brand tiles up to 6' height & Geyser point.

ELECTRICALS:

Modular Electrical Switches & Wires of Reputed Brands with ISI mark.

PAINTS:

Distemper Paint (Inside) Weather Coat (Outside).

WALLS:

8" Exterior and 5" Interior Walls.

BOUNDARY WALLS:

5"Height on all sides of Premises with M.S. Grill Gate.



PAYMENT SCHEDULE:

- Initial booking amount Rs-1, 00,000/- (Rupees One Lakh)only
- 1st Installment within 7days of allotment and on or before Execution of sale agreement.

(-Less booking amount) @ 30%

• 2nd Installment on completion of slab of the respective floor @ 25%

• 3rd Installment on completion of Brick work of the respective flat @ 25%

• 4th Installment on completion of Flooring of the respective flat @ 15%

• 5th Installment on completion of flat and before possession @ 05%

1. Maintenance charges for One year in advance Rs. 30,000

2. Electric Meter & Transformer. Rs. 1,00,000

3. GST @5% of Total Cost.

4. Registration charges pay at the time of registration.



Flat No. 001, The Royal Homes
Vivekananda Marg, Bhubaneswar-751002

p: 0674-2431652

e: info@bhavishyahomes.com

www.bhavishyahomes.com

For Details
94370 15112 /  77352 15112

